

High Security Padlocks

High Security Padlocks

130 Series High Security Padlock

The Lockwood High Security 130 Series Padlock is a 70mm cylindrical stainless steel padlock designed for high security and high corrosion resistance applications.

Features and Specifications

- Precision seam welded stainless steel case with drain holes
- Enclosed 9.5mm hardened alloy steel shackle
- Non-corroding internal components
- Pin tumbler mechanism
- Key retention in the unlocked position
- Available in DP, KD and KA

Security

Security Rating 7
Corrosion Resistance Rating 4

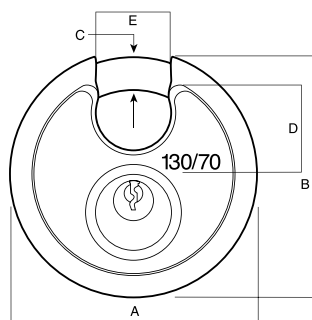

Dimensions and Ratings

	A	B	C	D	E	Security Rating	Corrosion Resistance Rating
130/70/125	70	67	9.5	16.5	20	7	4

High Security Padlocks

334 Series High Security Brass Case Padlocks with Rapid Change Shackle



The Lockwood High Security 334 Series Brass Case Padlock range features shackles designed for high security and high corrosion applications.

Suitability

- Commercial and industrial applications

Features and Specifications

- Heavy duty, solid brass case extrusion
- High corrosion resistant 8.7mm boron steel rapid change shackle
- Rapid change function allows the release of the shackle by turning the key and depressing the pin
- Double ball locking
- Extended shackle models
- Stainless steel shackle models
- Standard as latching function
- Can be converted to deadlocking (key retained) by simply relocating the cam plate pin in the cylinder assembly

Cylinders

334 top loaded cylinders are rekeyable in standard 5 pin with 6 pin capability (nickel silver keys with 6 pin padlocks).

334 cylinders are preloaded with one length top pins and stainless steel pin springs using a Lockwood 570 barrel.

Custom Marking

Custom marking is available. Pricing and availability on application.

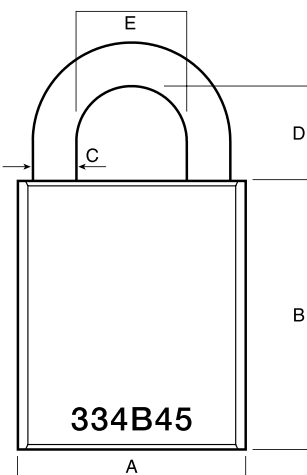
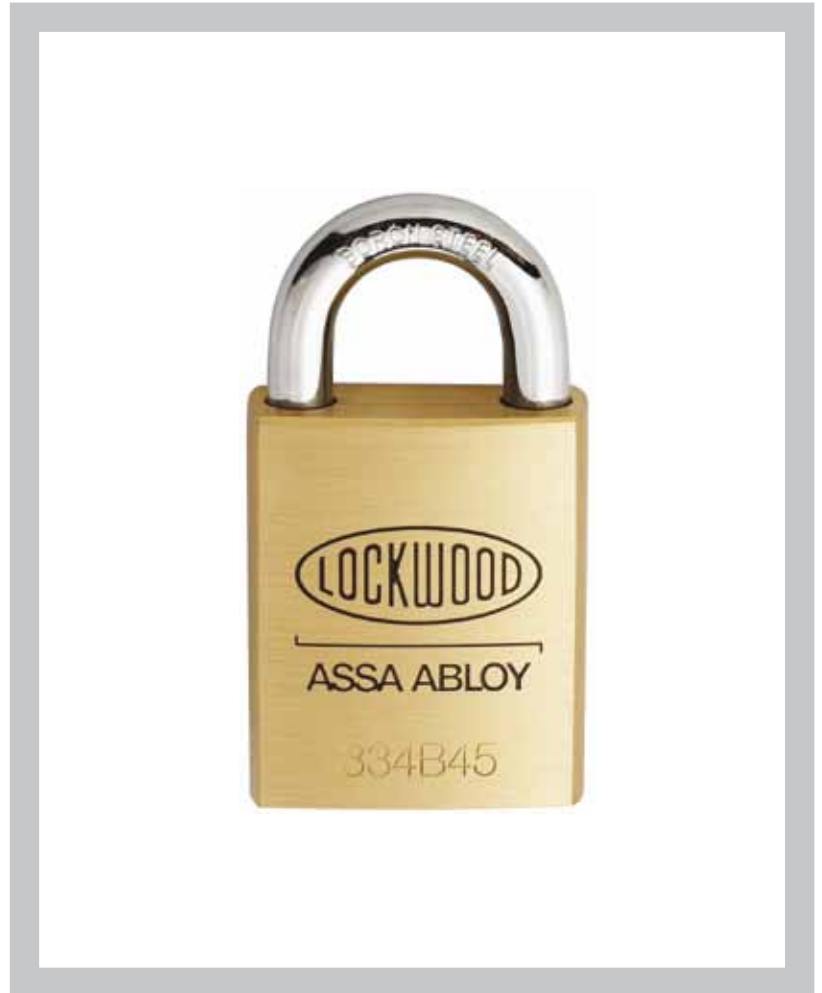

Dimensions and Ratings

	A	B	C	D	E	Security Rating	Corrosion Resistance Rating
334B45/119	45	55	8.7	19	22	7	4
334B45/138	45	55	8.7	38	22	6	4
334B45/148	45	55	8.7	48	22	6	4
334B45/190	45	55	8.7	90	22	5	4

Available Pack Variations

	DP	RKA	BK	5KA	5KD	6KA	6KD	6MK
334B45			•	•	•	•	•	•
334B45/119	•	•	•	•	•	•	•	•
334B45/138	•			•	•	•	•	•
334B45/148	•			•	•	•	•	•
334B45/190	•			•	•	•	•	•

High Security Padlocks

334 Series High Security Steel Case Padlocks

The Lockwood High Security 334 Steel Series Padlock range features shackles designed for high security for and high corrosion applications offering added protection against attack.

Suitability

- Commercial and industrial applications

Features and Specifications

- Heavy duty, solid steel case
- High corrosion resistant 8.7mm chrome molybdenum steel alloy shackle
- Double ball locking
- Extended shackle models
- Standard as latching function
- Can be converted to deadlocking (key retained) by simply relocating the cam plate pin in the cylinder assembly

Cylinders

334 top loaded cylinders are rekeyable in standard 5 pin with 6 pin capability (nickel silver keys with 6 pin padlocks).

334 cylinders are preloaded with one length top pins and stainless steel pin springs using a Lockwood 570 barrel.

Custom Marking

Custom marking is available. Pricing and availability on application.

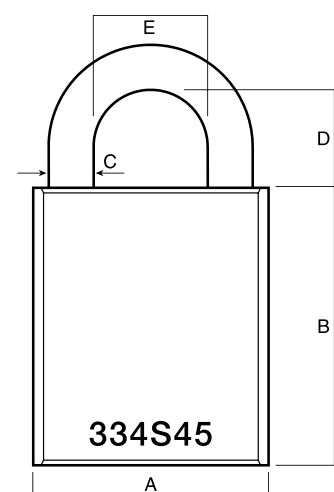

Dimensions and Ratings

	A	B	C	D	E	Security Rating	Corrosion Resistance Rating
334S45/519	45	55	8.7	19	22	8	4
334S45/538	45	55	8.7	38	22	7	4
334S45/548	45	55	8.7	48	22	7	4
334S45/590	45	55	8.7	90	22	6	4

Available Pack Variations

	BK	5KA	5KD	6KA	6KD	6MK
334S45	•	•	•	•	•	•
334S45/519	•	•	•	•	•	•
334S45/538		•	•	•	•	•
334S45/548		•	•	•	•	•
334S45/590		•	•	•	•	•

High Security Padlocks

334 Series High Security Shrouded Steel Case Padlocks



ASSA ABLOY

The Lockwood High Security 334 Steel Series Padlock range features shackles designed for high security for and high corrosion applications offering added protection against attack.

Suitability

- Commercial and industrial applications

Features and Specifications

- Heavy duty, solid steel case with shackle shroud
- High corrosion resistant 8.7mm chrome molybdenum steel alloy shackle
- Double ball locking
- Extended shackle models
- Stainless steel shackle models
- Standard as latching function
- Can be converted to deadlocking (key retained) by simply relocating the cam plate pin in the cylinder assembly

Cylinders

334 top loaded cylinders are rekeyable in standard 5 pin with 6 pin capability (nickel silver keys with 6 pin padlocks).

334 cylinders are preloaded with one length top pins, stainless steel pin springs using a Lockwood 570 barrel.

Custom Marking

Custom marking is available. Pricing and availability on application.

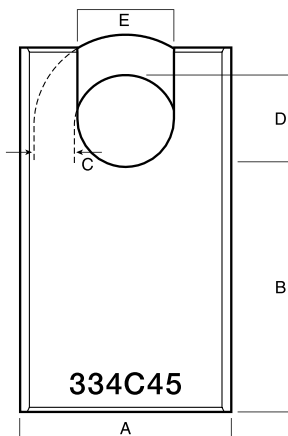

Dimensions and Ratings

	A	B	C	D	E	Security Rating	Corrosion Resistance Rating
334C45/519	45	79	8.7	19	19	8	4

Available Pack Variations

	DP	BK	5KA	5KD	6KA	6KD	6MK
334C45		•					
334C45/519	•	•	•	•	•	•	•

High Security Padlocks

334 Series High Security Stainless Steel Case Padlocks

The Lockwood High Security 334 Series Stainless Steel Padlock features stainless steel shackles designed for high security and high corrosion marine applications.

Suitability

- Commercial and industrial applications

Features and Specifications

- Heavy duty, solid stainless steel case
High corrosion resistant 8.7mm stainless steel shackle
- Double ball locking
- Extended shackle models
- Standard as latching function
- Can be converted to deadlocking (key retained) by simply relocating the cam plate pin in the cylinder assembly

Cylinders

334 top loaded cylinders are rekeyable in standard 5 pin with 6 pin capability (nickel silver keys with 6 pin padlocks).

334 cylinders are preloaded with one length top pins and stainless steel pin springs using a Lockwood 570 barrel.

Custom Marking

Custom marking is available. Pricing and availability on application.

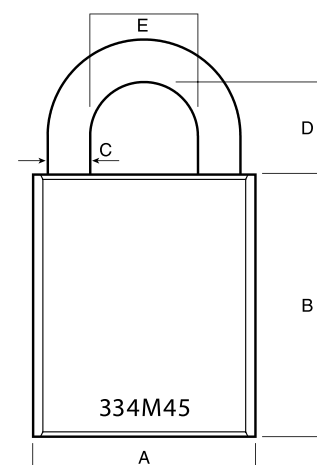
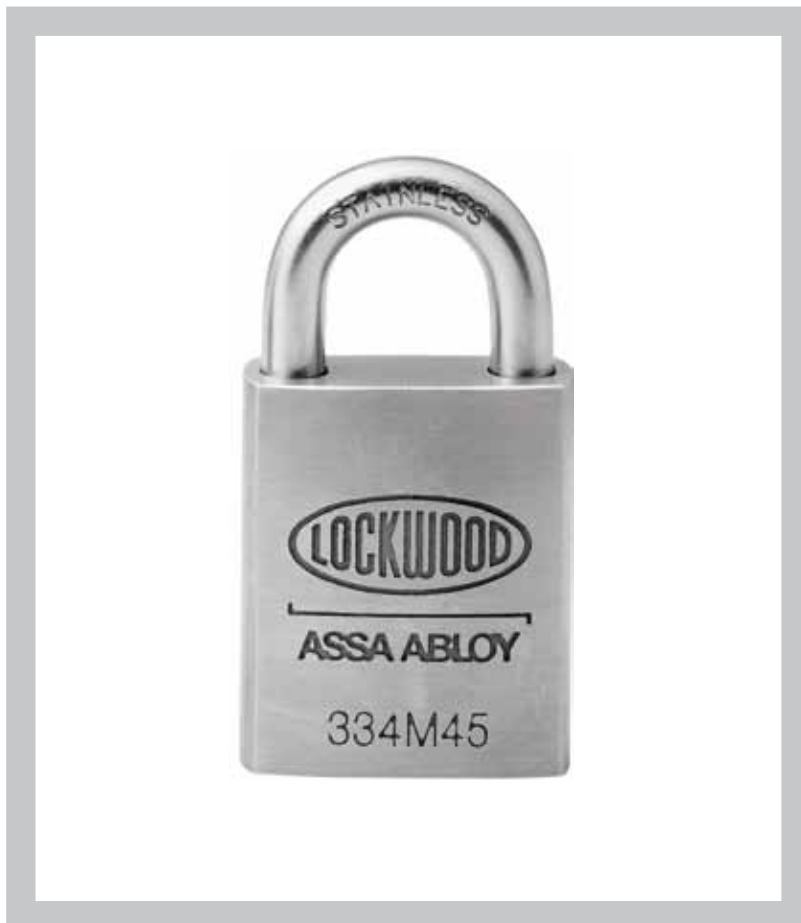

Dimensions and Ratings

	A	B	C	D	E	Security Rating	Corrosion Resistance Rating
334M45/619	45	55	8.7	19	22	7	5
334M45/638	45	55	8.7	38	22	6	5
334M45/648	45	55	8.7	48	22	6	5
334M45/690	45	55	8.7	90	22	5	5

Available Pack Variations

	DP	BK	5KA	5KD	6KA	6KD	6MK
334M45		•	•	•	•	•	•
334M45/619	•	•	•	•	•	•	•
334M45/638		•	•	•	•	•	•
334M45/648		•	•	•	•	•	•
334M45/690		•	•	•	•	•	•

ASSA ABLOY is the global leader in door opening solutions, dedicated to satisfying end-user needs for security, safety and convenience



Lockwood is the leading brand in the Australian locking industry. With an established reputation for high quality products, this iconic brand provides a wide range of locking solutions to residential housing, commercial building and industrial application markets. Lockwood is supported by an extensive distribution and after-sales support network. Our customers include retailers, architects, trade and industrial personnel, locksmiths and security dealers.

ASSA ABLOY

ASSA ABLOY is the global leader in door opening solutions, dedicated to satisfying end-user needs for security, safety and convenience.

ASSA ABLOY is represented in all major regions, in both mature and emerging markets, with leading positions in Australia, Europe and North America.

As the world's leading lock group, ASSA ABLOY offers a more complete product range of door opening solutions than any other company in the market.

Australia
1300 LOCK UP (1300 562 587)
lockweb.com.au

New Zealand
+64 9415 7111
assaabloy.co.nz

ASSA ABLOY Australia Pty Ltd
235 Huntingdale Road
Oakleigh, Victoria, 3166
Australia

info.au@assaabloy.com
assaabloy.com.au

ASSA ABLOY New Zealand Ltd
6 Armstrong Road
Albany, North Shore City, 0632
New Zealand

info.nz@assaabloy.com
assaabloy.co.nz

